



- Compact for High Density PCB Mount
- DC Control, DC Output
- Cost Effective Solution
- High Switching Speed
- Low Control Power
- Mosfet or Bipolar Transistor Output

The CR series are directly compatible with the industry standard 6.2mm relay interface modules, offering a high reliability solid state switching solution for application where mechanical relays have a limited lifetime.

Crydom solid state products offer optimum performance and quality.

### CURRENT DERATING CURVES

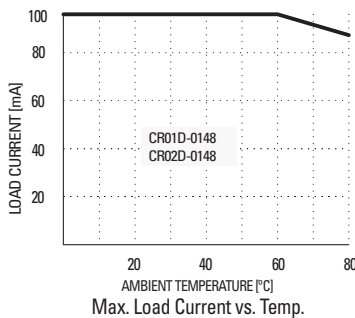
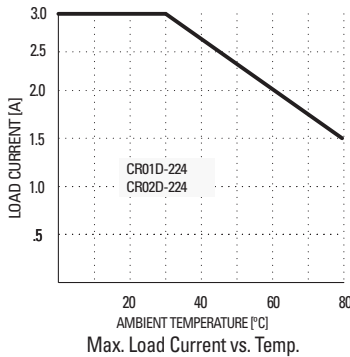

### MECHANICAL OUTLINE

#### Dimensions

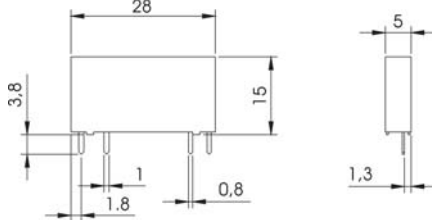

#### Mounting hole Layout

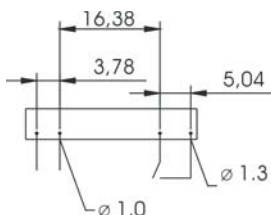

Note: Dimensions in [mm]

MODEL NO.	CR01D-224 CR01D-0148	CR02D-224 CR02D-0148
<b>INPUT SPECIFICATIONS</b>		
Nominal Control Voltage	24 Vdc	60 Vdc
Control Voltage Range	15-30 Vdc	35-72 Vdc
Nominal Input Impedance	3.2 KOhm	21.3 KOhm
Typical Input Current @ Nominal Voltage	7 mA	3 mA
Must Turn On Voltage	15 Vdc	35 Vdc
Must Turn Off Voltage	10 Vdc	20 Vdc

MODEL NO.	CR01D-224 CR02D-224	CR01D-0148 CR02D-0148
<b>OUTPUT SPECIFICATIONS</b>		
Nominal Voltage	24 Vdc	48 Vdc
Operating Voltage Range	0-24 Vdc	0-48 Vdc
Max. Blocking voltage	33 Vdc	60 Vdc
Max. Load Current @ 20°C @ 60°C	3A 2A	100 mA 100 mA
Min. Load Current	0.05 mA	0.05 mA
Max. On-State Voltage Drop @ Rated Current	120 mVdc	1.0 Vdc
Max. Off-State Leakage	50 µA	1.0 µA
Max. Turn-On Time	90 µS	18 µS
Max. Turn-Off Time	280 µS	90 µS

### GENERAL SPECIFICATIONS

Dielectric Strength	2500 Vrms
Ambient Operating Temperature Range	-20 to 80 °C
Ambient Storage Temperature Range	-40 to 100 °C

### GENERAL NOTES

- ① All parameters at 25° C unless otherwise specified.
- ② Dielectric strength and insulation resistance measured between input and output.

© 2005 CRYDOM CORP, Specifications subject to change without notice.

### APPROVALS

UL: ML File E116950

For recommended applications and more information contact:  
**USA:** Sales Support (877) 502-5500 **Tech Support** (877) 702-7700 FAX (619) 710-8540  
 Crydom Corp, 2320 Paseo de las Americas, Ste. 201, San Diego, CA 92154  
**Email:** sales@crydom.com **WEB SITE:** http://www.crydom.com  
**UK:** +44 (0)1202 365070 • **FAX** +44 (0)1202 365090 Crydom International Ltd., 7 Cobham  
 Road, Ferndown Industrial Estate, Ferndown, Dorset BH21 7PE, Email: intsales@crydom.com.  
**GERMANY:** +49 (0)180 3000 506

